

73

74

75

316 E. Main St.

MORTGAGE LOCATION CERTIFICATE

for JAMES H. GILLILAND 316 E. MAIN STREET, NAPOLEON

EAST HALF 1/2, LOT 55, of the ORIGINAL PLAT, CITY OF NAPOLEON, HENRY COUNTY, OHIO

Federal Emergency Management Agency
Flood Insurance Rate Maps
City of Napoleon, Henry County
Community Panel Number 390266 0005 D
Effective Date Nov. 2, 1995
Zone X Area of 500-year flood

I hereby certify that I have inspected the above described property for the purpose of locating the buildings described and shown on this drawing, and that they are within the property lines and bear no encroachments, unless noted. No property corners were set. This drawing does not represent the establishment nor the verification of boundary locations, and is not to be used for any other purpose than that required by the title company or First National Bank of Northwest Ohio.

Wayne Aschemier

WAYNE ASICHEMIER R. L. S. 5922
REGISTERED LAND SURVEYOR

LEGEND 53

A - CROSS IN SIDEWALK
B - IRON PIN FOUND

DWG. NO. D-3641-S
DATE APRIL 2, 1996
SCALE 1" = 40'

JEFFERSON ST.

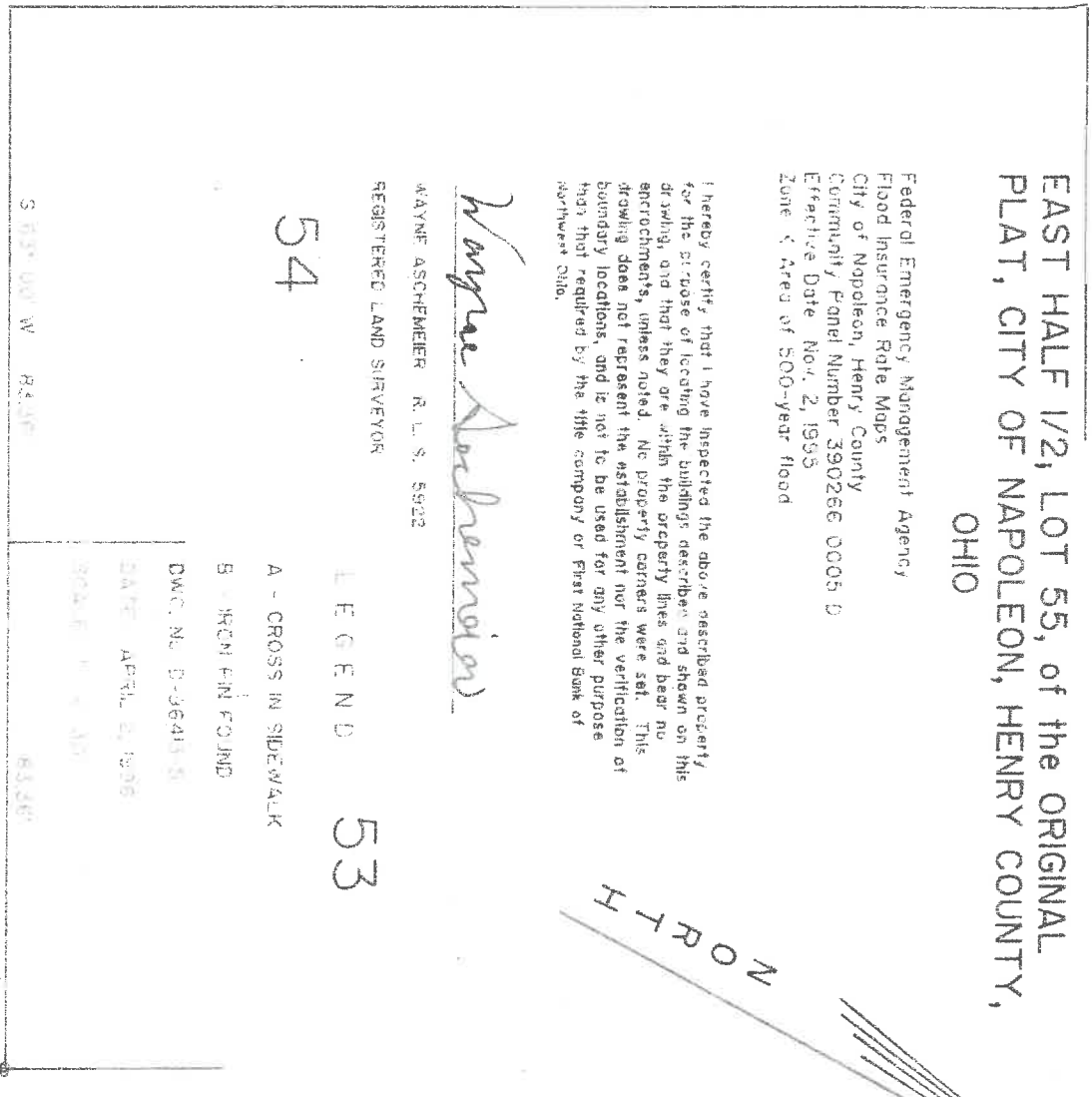
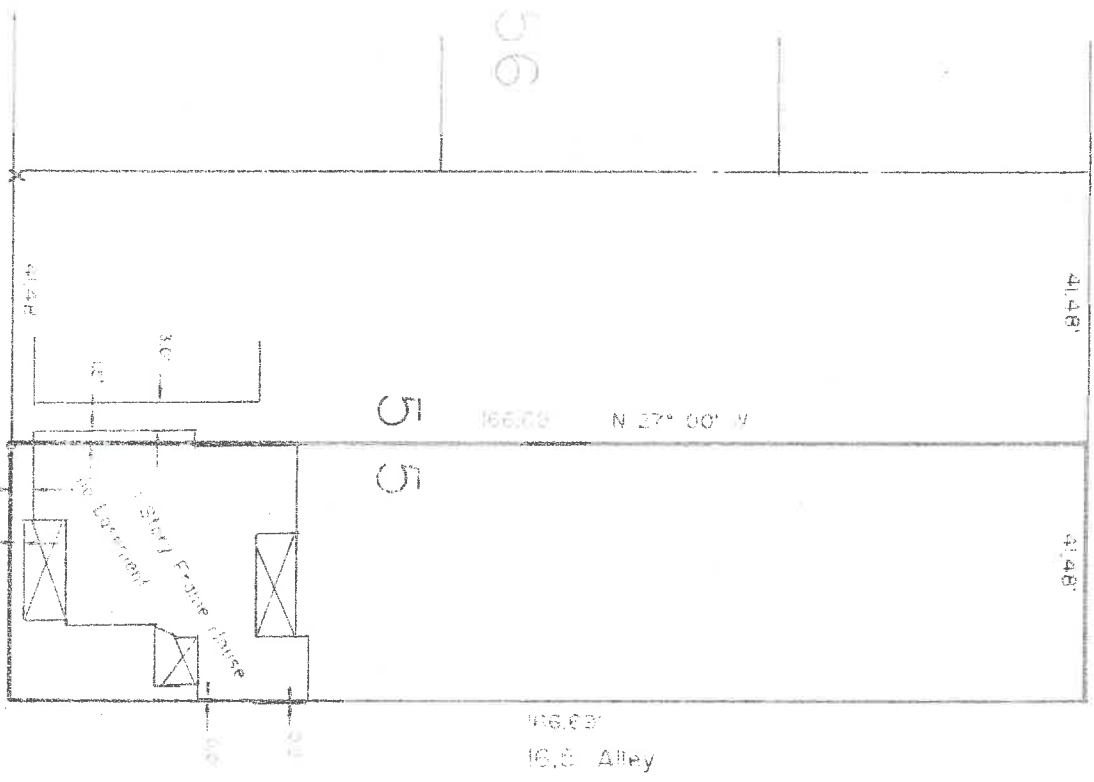

EAST MAIN ST. 82.5' R/W

WAYNE ASICHEMIER SURVEYING
P. O. BOX 31
2510 W. 10th Street, Napoleon, Ohio 43555
Phone: 287-4523